

Eslon Clean Fittings
45° Elbow

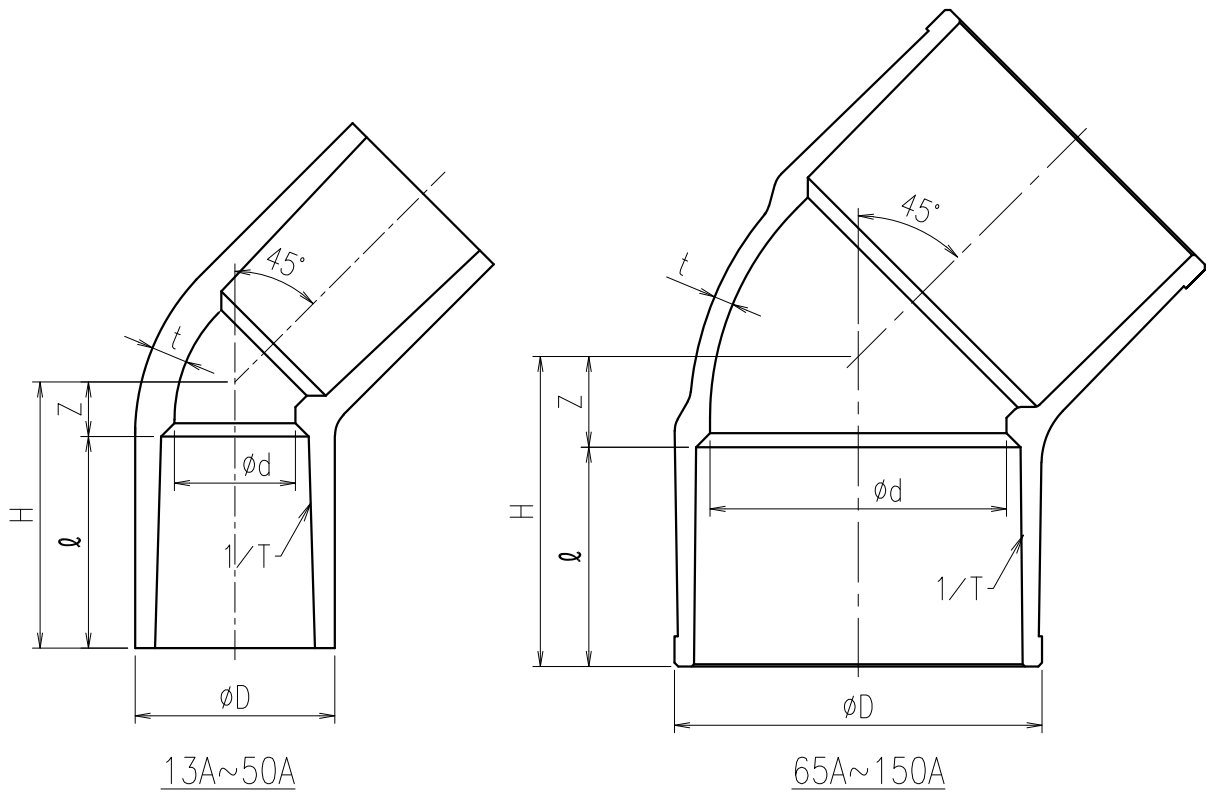

Dimension Table

Unit:mm

Size	A(B)	ϕD	H	Z	ϕd	1/T	ρ	t
□	13(3/8)	24	36	10	13	1/30	26	3.0
□	20(3/4)	33	44	9	20	1/34	35	3.5
□	25(1)	40	51	11	25	1/34	40	4.0
□	30(1·1/4)	46	56	12	31	1/34	44	4.0
□	40(1·1/2)	57	69	14	40	1/37	55	4.5
□	50(2)	70	81	18	51	1/37	63	5.0
□	65(2·1/2)	87	94	33	67	1/48	61	5.0
□	75(3)	102	98	34	77	1/49	64	8.0
□	100(4)	130	123	39	100	1/56	84	10.0
□	125(5)	160	149	44	125	1/58	105	11.0
□	150(6)	190	184	51	146	1/63	133	13.5

Eslon Clean Fittings 45° Elbow		DWG No.
		HL20ATTVE
SEKISUI SEKISUI CHEMICAL CO.,LTD.	Date	Approved by:
	2010.06.08	

45° Elbow
200~300A

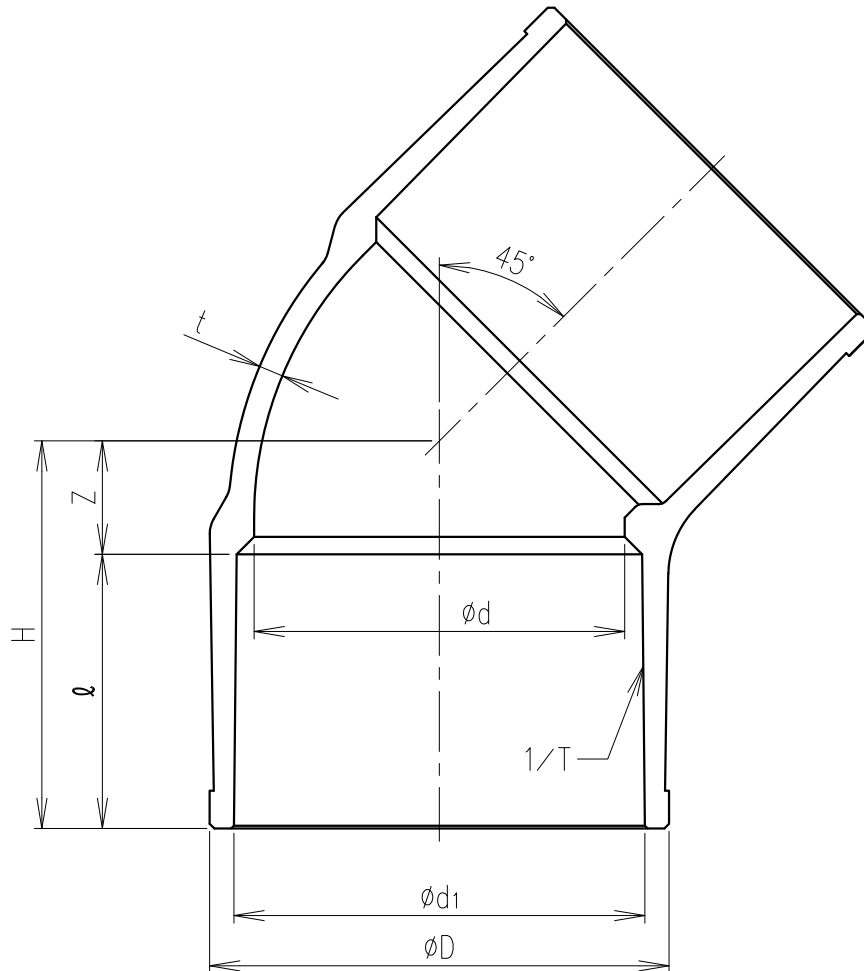

Dimension Table

Unit:mm

Size	A(B)	ϕD	H	Z	ϕd	ϕd_1	1/T	ℓ	t	Nominal pressure (MPa)
<input type="checkbox"/> 200(8)	200(8)	243	205	60	196	217.4±0.7	1/50	145	13.0	0.75
<input type="checkbox"/> 250(10)	250(10)	300	254	79	242	268.6±0.7	1/50	175	14.5	0.75
<input type="checkbox"/> 300(12)	300(12)	356	280	95	288	319.8±0.8	1/50	185	16.0	0.60

Material

- Esloclean
- HI-PVC
- U-PVC

45° Elbow 200~300A		DWG No.
		HL200TVE
SEKISUI SEKISUI CHEMICAL CO.,LTD.	Date	Approved by:
	2010.10.27	

2-2011.12.05

HT Eslon Fittings
45° Elbow

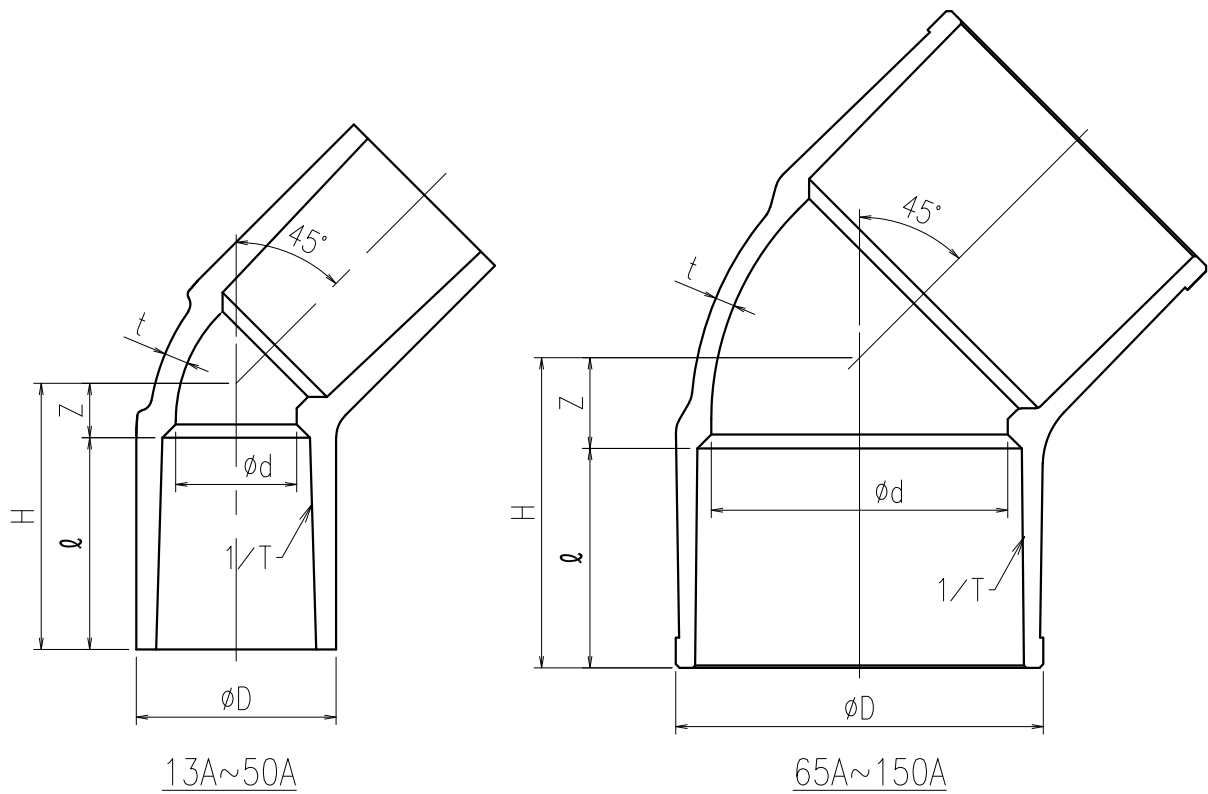

Dimension Table

Unit:mm

Size	A(B)	ϕD	H ± 4	Z	ϕd	1/T	l	t
□	16 (1/2)	29	33	8	17	1/34	27	3.5
□	20 (3/4)	34	44	9	21	1/39	33	4.0
□	25 (1)	41	50	10	26	1/35	38	4.0
□	30 (1·1/4)	46	53	13	34	1/40	42	4.5
□	40 (1·1/2)	56	61	16	40	1/45	47	4.5
□	50 (2)	69	80	26	50	1/50	52	5.0
□	65 (2·1/2)	91	94	24	67	1/48	70	6.1
□	75 (3)	106	98	26	77	1/52	75	7.5
□	100 (4)	134	121	30	100	1/55	94	9.4
□	125 (5)	166	149	44	125	1/58	104	11.0
□	150 (6)	189	184	51	146	1/63	132	13.5

HT Eslon Fittings 45° Elbow		DWG No.
		HL20ATTTE
SEKISUI SEKISUI CHEMICAL CO.,LTD.	Date	Approved by:
	2010.06.08	