

Operating Temperature(°C)

PVC 0 ~ 50

ESLON ELECTRIC 3-WAY BALL VALVE

Feature

- Open/close position and flow rate control in 3-way
- Light weight and compact of actuator with aluminum die-cast housing.
- Excellent chemical and corrosion resistance.
- Visually confirmable valve action and open-close position, available manual open-close operation.

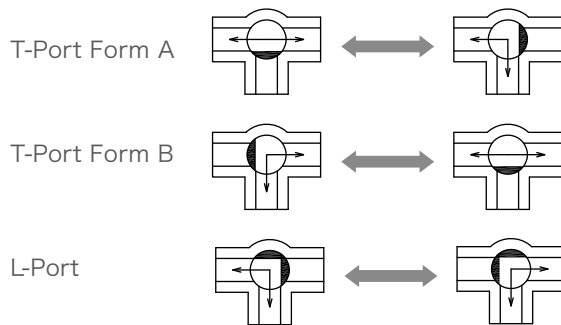

Specification of Actuator

Nominal diameter(A)	15~25A	32~50A
Input system	Power switching system	
Contact output	Power supply voltage	
Operating voltage	Single-phase AC100/110,200/220V(50/60Hz)	
Motor	Type	Synchronous motor Reversible motor
	Time rating	15 minutes rating under loading rate 20%
Protect	Thermal protect inside	
Power consumption	19VA	60VA
Manual operation	Drive shaft direct operation	
Connector type	G1/2 conduit (Cable connector) (Φ6-12 cabtire cable)	
Material	ADC Resin Coating	
Protection	IP65	
Condensation prevention	Built-in space heater	

Time For Open-Close (50/60Hz)

Size (A)	Time(Sec.)
15-25A	9.5/8
40,50A	7.6/6

⚠ Important Notes

- Do not use for the fluid containing slurry, solid, sediment, or crystallized fluid. Or for those kinds of fluid, strainer should be used in upstream.

Maximum Working Pressure - Temperature Rating

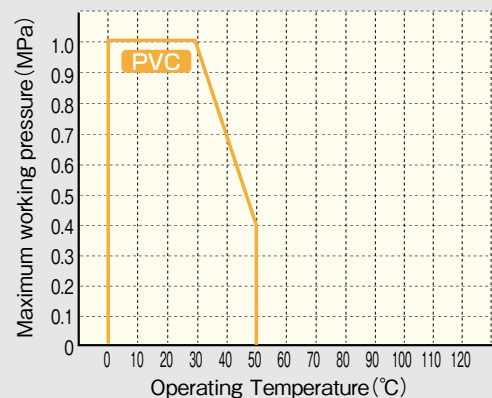
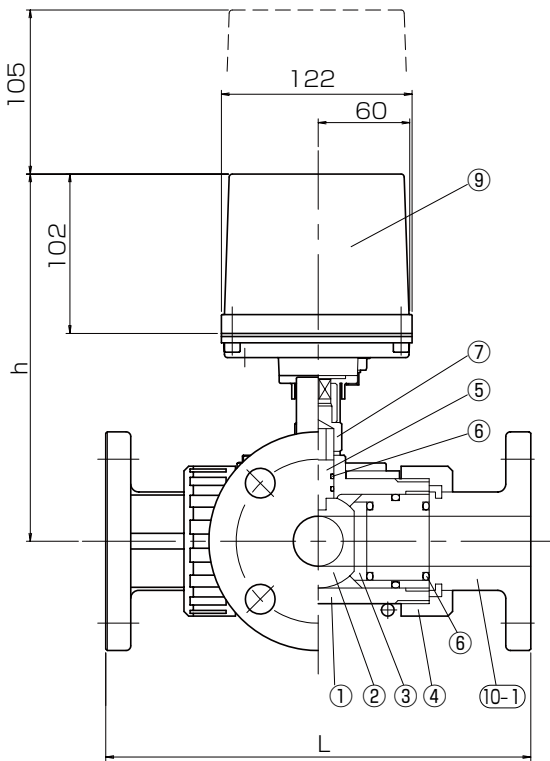
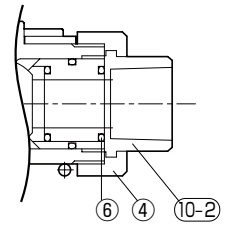

Figure (Flange Type · TS Socket Type · Thread Type)

● Flange Type



● TS Socket Type



● Thread Type

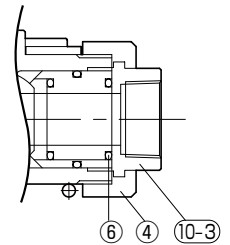

Parts List

No.	Part Name	QTY	Material / Type
1	Body	1	PVC
2	Ball	1	PVC
3	Ball holder	2	PVC
4	Union nut	3	PVC
5	Stem	2	PVC
6	O-ring	11	● EPDM ● FKM
7	Connector	1	C3604BD
8	Yoke	1	SCS13
9	Actuator	1	ADC+Resin Coating
10-1	Flange,Set ring	3	PVC
10-2	TS Socket	3	PVC
10-3	Threaded socket	3	PVC

Option

- No-voltage limit switch
- Space heater (Standard)

Size

Flange Type · Thread Type · TS Socket Type

Unit : mm

Size		L			L ₁			h	Actuator		Ref. Weight (kg/unit)		Actuator
A	B	Flange	TS Socket	Thread	Flange	TS Socket	Thread		A	B	Flange	TS, Thread, Butt	
15	1/2	163	129	118	82	65	59	202	145	122	3.7	3.2	AE-120
20	3/4	200	151	134	100	76	67	206	145	122	3.9	3.4	AE-120
25	1	221	175	156	111	88	78	221	145	122	4.5	3.6	AE-120
40	1 1/2	272	232	203	136	116	102	235	145	122	5.8	4.9	AE-300
50	2	306	260	225	153	130	113	246	145	122	7.3	5.7	AE-300