

JIS ISO*
*Butt spigot only



Operating Temperature(°C)

PVC	0 ~ 50
PP	10 ~ 70
PVDF	-30 ~ 100



ESLON RELIEF VALVE Type712

Feature

- De-pressure and prevent from the damage of piping line by excess pressure
- Pressure adjustment range of 0.03 - 1.0 MPa
- Reliable relief performance in both horizontal and vertical direction of pipe line
- Superior corrosion & chemical resistance as all plastic component for contact parts with medium.

⚠ Important Notes

- Fluid containing slurry, solid, sediment, or crystallized fluid might disable sealing.

Maximum Working Pressure - Temperature Rating

Body material : PVC

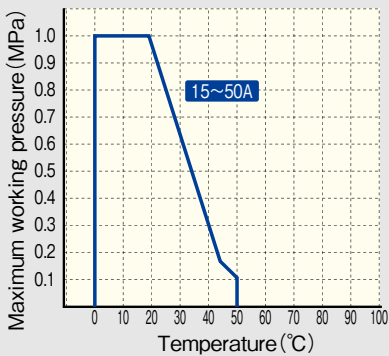

Body material : PP

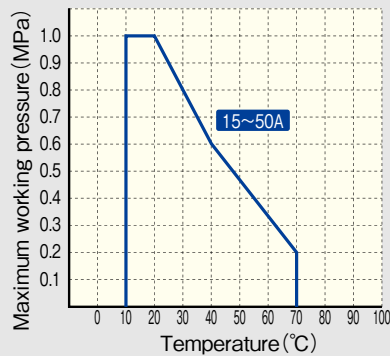

Body material : PVDF

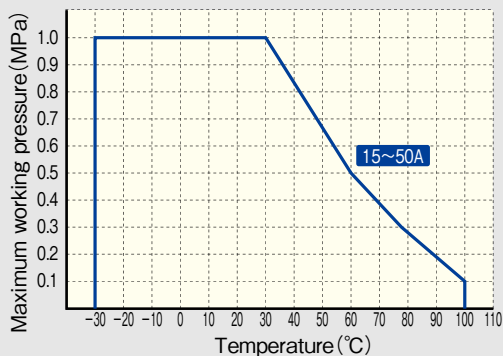
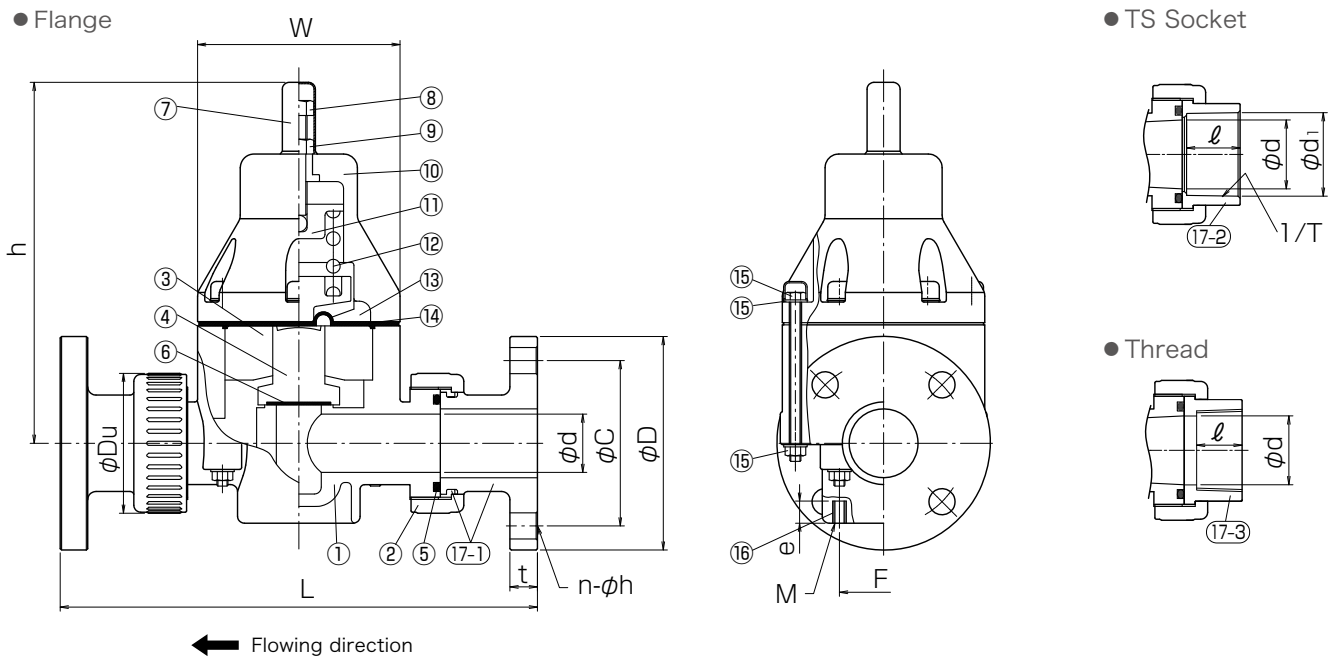

Figure (Flange Type · TS Socket Type · Thread Type)



Parts List

No.	Part Name	Q'TY	Material	No.	Part Name	Q'TY	Material
1	Body	1	● PVC ● PP ● PVDF	10	Bonnet	1	GF-PP
2	Union nut	2		11	Pressure plate	1	SS400+Ni plating
3	Separate disc	1	PVC	12	Pressure spring	1	Spring steel
4	Piston	1	PVC	13	Pressure disc	1	SUS304
5	O-ring	2	● EPDM ● FKM	14	Diaphragm	1	PTFE + EPDM
6	Gasket	1		15	Bolt,Nut,Washer	-	SUS304
7	Cover	1	PE	16	Fixing insert nut	1	SUS304
8	Adjust bolt	1	SUS304	17-1	Flange end,Set ring	2	● PVC ● PP ● PVDF
9	Lock nut	1	SUS304	17-2	TS socket	2	● PVC
				17-3	Threaded	2	● PVC ● PVDF

·For PVDF body type, sealing material is FKM.
·For PVDF body type, butt spigot is available,too. Contact us for more information.

Size

Flange Type

Unit : mm

Size		d	h	W	Fixing Insert Nut		Flange JIS10K					Weight(kg/unit)			
A	B				F	Mxe	L	ϕD		C	n- ϕh	t	PVC	PP	PVDF
							PVC	PP,PVDF							
15	1/2	15	174	81	40	M6x16	224	95	92	70	4-15	14	1.2	0.9	1.5
20	3/4	20	202	107	46	M6x16	255	100	97	75	4-15	14	1.3	1.8	1.6
25	1	26	202	107	46	M6x16	269	125	122	90	4-19	14	2.5	2.0	2.9
32	1 1/4	32	262	147	65	M8x16	323	135	132	100	4-19	16	5.8	4.6	6.4
40	1 1/2	40	262	147	65	M8x16	338	140	137	105	4-19	16	6.0	4.7	6.6
50	2	50	262	147	65	M8x16	346	155	152	120	4-19	20	6.4	5.1	7.1

*ANSI,DIN:Please contact us

TS Socket Type · Thread Type

Unit : mm

Size		d	h	W	Fixing Insert Nut		TS socket JIS				Thread JIS			Weight(kg/unit)	
A	B				F	Mxe	L	ϕd_1	1/T	ℓ	L	Rc	ℓ	PVC	PVDF
13	3/8	10	172	81	40	M6x16	172	18.3	1/31	19	158	Rc3/8	15	0.9	1.1
15	1/2	15	172	81	40	M6x16	174	22.3	1/37	22	161	Rc1/2	17	1.0	1.2
20	3/4	20	202	107	46	M6x16	213	26.3	1/42	25	195	Rc3/4	18	2.0	2.2
25	1	26	202	107	46	M6x16	220	32.3	1/43	29	201	Rc1	18	2.0	2.3
32	1 1/4	32	262	147	65	M8x16	278	38.4	1/37	32	267	Rc1 1/4	23	5.1	5.6
40	1 1/2	40	262	147	65	M8x16	284	48.5	1/38	35	277	Rc1 1/2	23	5.2	5.7
50	2	50*	262	147	65	M8x16	293	60.6	1/34	38	292	Rc2	28	5.3	5.8

*TS socket:54 *ASTM,ANSI,DIN:Please contact us

Pressure characteristic at Inlet Side

The below diagram show the relation of flow rate and pressure increase at inlet. Pressure at inlet increase with increasing flow rate.

